



GENTECH
POWER POWER WHEN YOU NEED IT

**POWER
WHEN YOU
NEED IT**

2
YEAR
WARRANTY

Operators Manual

Please note: This manual is designed for the GPWP20 and GPWP30 water pump. The images used in the guide are for reference only and may differ slightly to the product itself.

Table of Contents

IMPORTANT.....	1
Chapter I Instructions to Open-Package	3
Chapter II Safety Rules.....	4-5
Chapter III Product Structure and Description	6-7
Chapter IV Main Parameters	8
Chapter V Use and Operation	9-12
Chapter VI Repair and Maintenance.....	13
Chapter VII Troubleshooting	14-15
Chapter VIII Transportation and Storage.....	16
Chapter IX Warranty Description	17

IMPORTANT

Thank you for purchasing a GENTECH POWER & SHINERAY Gasoline Water Pump(hereinafter referred to as the "water pump"). This manual will assist you in operating and maintaining your water pump. This manual is the latest version.

With the continuous improvement and upgrading of this product, the manufacturer reserves the right to modify this manual without notice. The manufacturer shall assume no liability for incorrect information contained in this manual.

This manual is an integral part of the water pump. When the water pump is transferred to others, this manual should be handed over to the new owner.

Some important information in this manual will be indicated in the following way. The users should pay special attention to these instructions.

	Danger	<i>This indicates a hazardous situation, which, if not avoided, will result in death or serious injury.</i>
---	---------------	---

	Warning	<i>This indicates a hazardous situation, which, if not avoided, could result in death or serious injury.</i>
---	----------------	--

	Caution	<i>This indicates a hazardous situation, which, if not avoided, could result in injury.</i>
--	----------------	---

Engine Oil:

Gentech Power now supply the correct amount of oil to all water pumps.



SAE 15W-40 Engine Oil
GPWP20 Oil Capacity: 600ml
GPWP30 Oil Capacity: 600ml



The range of GENTECH POWER & SHINERAY Products is safe and reliable, but incorrect use of these products may cause personal injury and or damage to your machine. Please read this manual thoroughly before operation as this product is required to operate strictly in accordance with this manual.

CHAPTER I

INSTRUCTION TO OPEN PACKAGE

Please note the following when opening the packaging for the first time:

- Please ensure that the machine is placed in an upright position.
- Please check that all the relevant booklets are included namely, Packing List, Operators Manual and Warranty Manual. Please then ensure that the products packaged in the box are in accordance to the packing list.
- The GENTECH POWER & SHINERAY Range is of the highest quality. In the unlikely event of you incurring any problems with this machine, please contact Gentech Industries for assistance. Please see the relevant contact details below.

GENTECH INDUSTRIES CC

CUSTOMER CARE: 0861GENFIX (436 349)

CHAPTER II

SAFETY PRECUATIONS:

	Danger		Warning		Caution
---	--------	---	---------	---	---------

1. Ensuring the safety of all operators:

This water pump must be operated strictly in accordance with the information specified in this Manual. Please make special notice of the points below. **Please do not be negligent**

- (1) Do not operate this machine until you have read through this manual thoroughly.
- (2) The water pump must be operated on a flat and secure surface. Place the water pump in a horizontal position before using. Uneven surfaces and the tilting of the machine may cause the fuel to over flow.
- (3) Before using the water pump ensure that you carry out a pre inspection in accordance with the steps listed in **Section 1 “Preparation before Startup” in Chapter V.**
- (4) In the unlikely event of excessive noise and or vibration whilst using the water pump we strongly recommend that you switch off the engine immediately.
- (5) Do not attempt to carry out any maintenance or re fueling whilst the water pump is in operation. Only do so when the machine is switched off.
- (6) After usage wait for the water pump to cool down before touching as the engine will be hot.

2. Safety Instructions:

	Danger		Warning		Caution
---	---------------	---	----------------	---	----------------

- (1) Do not operate the water pump in a closed environment. Always ensure that there is sufficient ventilation at all times as the water pump releases Carbon Monoxide which, if inhaled is harmful. Always ensure that the water pump is at least 1m (one meter) away from any buildings whilst in use.
- (2) Keep away from Children and Pets and do not allow them to be in close proximity whilst the water pump is in use.
- (3) When refueling the water pump try and avoid any spillage. If spillage occurs, please wipe/clean before operating.
- (4) Do not cover the water pump with anything whilst in use as this may result in a fire.

Chapter III

Product Structure and Description

1. Structural Diagram of Water Pump (Fig. 1)

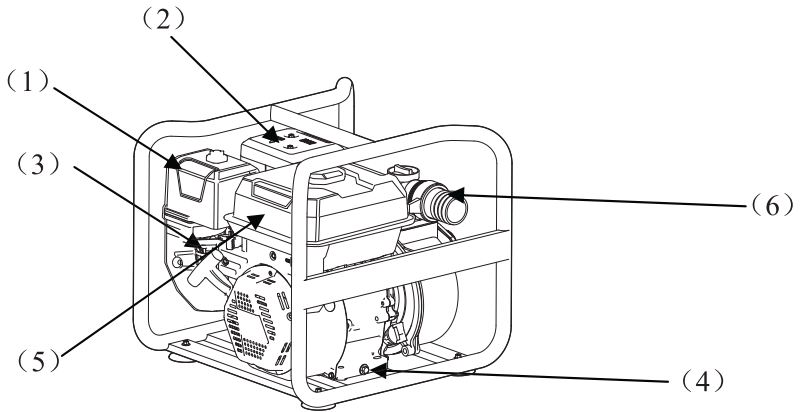

- (1) Air Cleaner
- (2) Muffler
- (3) Carburetor
- (4) Oil Dipstick
- (5) Fuel Tank
- (6) Pump

2. Operating Environment and Structure Description

The water pump is designed to convey/pump fresh water of normal temperature or water of which the quality conforms to GB5084 with a temperature of less than 40 degrees celcius.

This is an axial suction, horizontal, coaxial direct type centrifugal water pump. The impeller is semi-open or closed. The pump is single stage or multistage and single suction. The pump body is volute type, and the discharge is placed upward. The pump suction and discharge is a threaded or rapid joint connection. The mechanical seal is applied to the pump shaft seal. The rotary direction of the water pump is anticlockwise if viewed from the direction of the pump suction.

CHAPTER IV

MAIN PARAMETERS:

Table 2 Main Parameters

	<u>Model</u>	<u>GPWP20</u>	<u>GPWP30</u>
Pump	Suction/discharge diameter (mm)	50/50	80/80
	Flow rate of specified point (m³/h)	24	42
	Maximum lift (m)	30	25
	Suction lift (m)	7	7
	Self-priming time (s)	180	180
Engine	Supporting power model	SR170F	SR170F
	Displacement (ml)	208	208
	Rated power and relevant speed [kW/(r/min)]	3.8/3600	3.8/3600

CHAPTER V

USE AND OPERATION:

1. Preparation and Inspection before each use

To ensure your safety as well as the maximum life span of your water pump please read below:

- (1) Please check tht each bolt is tight before operating your water pump as some of them may become loose due to the vibration of the water pump whilst in use. Replace any missing bolts immediately.
- (2) Before using the water pump check the oil level, ensure that the unit is on a flat and level surface when doing this and that the unit is "OFF". The recommended oil to use is 4 - stroke SAE engine oil 15W-40

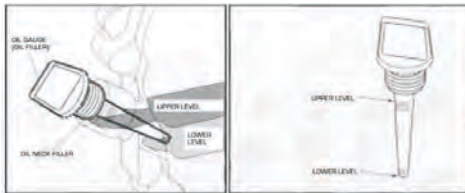

2.1 OIL CAPACITY FOR THE VARIOUS WATER PUMPS MODELS:

2.1A GPWP20 - 600ml

2.1B GPWP30 - 600ml

- (3) Check the water pump for any possible oil leakage. Do not operate the water pump if there is any notice of oil leaks.
- (4) Check that your water pump has sufficient fuel. If necessary re fuel prior to starting your water pump.

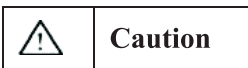

PLEASE NOTE THAT YOUR WATER PUMP DOES NOT COME WITH SUFFICIENT OIL FROM THE MANUFACTURER. PLEASE ENSURE THAT THERE IS SUFFICIENT OIL PRIOR TO OPERATING.

2. Installation of Water Pump (See Fig. 3~ Fig. 10)

① Filter ② Pipe joint connection ③ Pipe joint ④ Pipe joint gasket ⑤ Water inflow/outflow rubber hose ⑥ clamp



Fig. 3
(1) Connect the filter

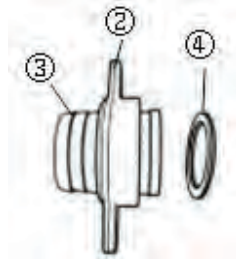

Fig. 4
(2) Assemble the pipe joint

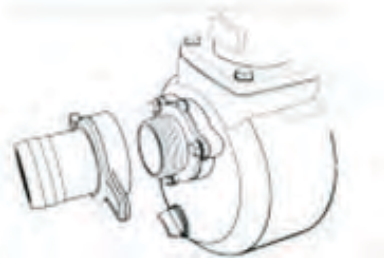

Fig. 5
(3) Install the water suction

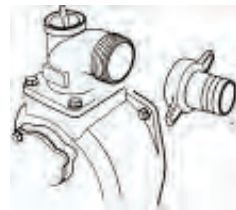

Fig. 6
(4) Connect the water discharge

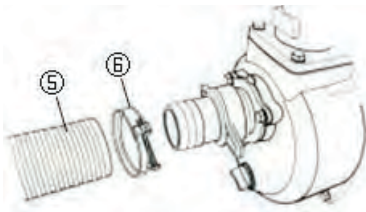

Fig. 7
(5) Connect the water suction pipe

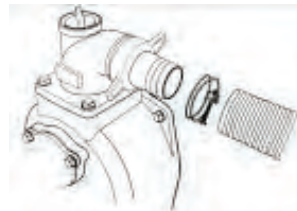

Fig. 8
(6) Connect the water discharge pipe

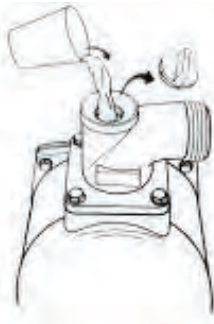

Fig. 9

(7) Prior to each use please fill with water. Unscrew the rubber plug and fill the pump body with clean water.

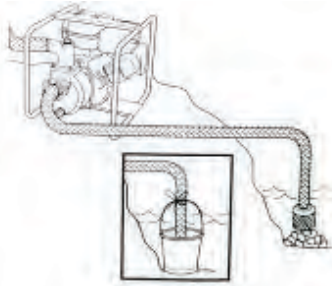
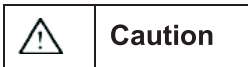

Fig. 10

(8) Place the filter into water and ensure that the water level exceeds 20cm above the filter. We recommend that you place the filter screen in a bucket or on a rock to avoid mud causing any blockages.



- ***The water suction pipe must be a continuous and unfolding structure. Its length should not exceed the required length. To ensure maximum performance from your water pump we recommend that your water pump is located as close to the point of suction as possible. The self-priming time is proportional to the length of the water suction pipe.***
- ***Select your water pipe in accordance to your conditions and model. To ensure your safety, the pressure bearing capacity of the water pipe should not be lower than the requirements listed in “Chapter IV”.***
- ***Do not operate beyond the lift of your water pump. If there is a decrease of water discharge flow caused by excessive lift,***

the liquid in the water pump may overheat and cause damage to the sealing.

- *To prevent any air leakage and or water discharge ensure that you fasten the pipe joint and pipe coupling clamp sufficiently. Any leakage will reduce the performance and self-priming capacity of your water pump.*
- *Do not attempt to operate your water pump without water. This will cause your water pump to overheat causing damage to the sealing.*

3. **Startup and Shutdown of Water Pump:**

Please refer to the engine specifications of your water pump when you switch it on and off.

4. **Maintenance after Shutdown:**

When turning your water pump off, remove the water suction and discharge pipes, and then unscrew the rubber plug of the discharge outlet (see Fig. 1). Drain away the residual water in your water pump. Wait for your water pump to cool down completely before trying to move it.

CHAPTER VI

REPAIRS AND MAINTENANCE:

Periodic inspection and services to your water pump is imperative to the performance and longevity.



- ***We recommend that you contact Gentech Industries to facilitate any services and or warranty requirements that you may have.***
- ***Do not attempt to carry out any maintenance to your water pump whilst it is in use. Always ensure that your water pump has cooled down sufficiently prior to touching it.***
- ***Smoking or any fire is extremely dangerous when using or repairing your water pump. DO NOT BE NEGLIGENT.***
- ***Do not attempt to pump salt/sea water or any water with high acidity through your water pump as this will cause extensive damage and will not be covered by your limited warranty policy.***

Refer to the ENGINE SECTION in this manual for any further assistance regarding repairs and maintenance to your water pump.

CHAPTER VII

TROUBLESHOOTING:

1. Common Water Pump Faults and Troubleshooting:

Fault	Possible Cause	Remedial Action
No water output from the water pump	Inadequate priming in pump	Unscrew the threaded rubber plug and add adequate priming
	Filter blockage	Try to clear the blockage
	Water suction does not sink into the water	Adjust the position of water suction so that the water suction is completely submerged into water
	Leakage of water suction pipe	Repair the leakage or replace the water suction pipe
	The installation height of the water pump is too high	Decrease the installation height of the water pump
	Filter blockage	Try to clear the blockage

Low flow rate of Water Pump	Leaking of the water suction pipe	Repair the leak or replace the water suction pipe
	The installation height of the water pump is too high	Decrease the installation height of the water pump
	The installation height of the water discharge is too high, or the water discharge pipe is too long	Decrease the height or length of the water discharge
	The water discharge pipe has a sharp bend in it	Avoid/remove the sharp bend of water discharge pipe
Abnormal Vibration	Cavity erosion of the water pump	Decrease the installation height and keep the water suction pipe unobstructed without blockage

If the above advice does not resolve your problem or the problem you are faced with is not mentioned in the table above please contact **Gentech Industries** for assistance.

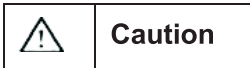

- The limited warranty terms and conditions does not cover your water pump if it is disassembled by a non approved service agent. For more information please read your warranty policy booklet or contact **Gentech Industries**.

CHAPTER VIII

TRANSPORTATION AND STORAGE:



- To avoid the possibility of a fire please wait until your water pump has cooled down completely prior to storing it in a confined space.
- Always ensure that you water pump is transported in the upright position.

Tips to follow when storing your water pump for long periods:

- (1) Clean your water pump properly
- (2) To avoid damaging the impeller of your water pump flush the unit properly with clean water to remove any mud and other sediments. Before doing this ensure that the drain plug has been removed.
- (3) Empty the fuel Tank
- (4) Replace with clean engine oil
- (5) Slowly pull the starter handle until you feel pressure
- (6) Clean the water pump surface and store it at a dry place.
- (7) Cover the water pump for dust protection

CHAPTER IX

WARRANTY DESCRIPTION:

THANK YOU FOR PURCHASING A GENTECH POWER & SHINERAY WATER PUMP

All GENTECH POWER & SHINERAY Products are strictly inspected prior to shipping to ensure that the quality is of the highest standard.

For all after sales service please contact **Gentech Industries.**

Please note the back page for all contact details.

For further information regarding your limited warranty policy please read through the Warranty Policy Booklet supplied

※ NOTES: PLEASE RETAIN YOUR PROOF OF PURCHASE IN THE UNLIKELY EVENT OF A WARRANTY CLAIM



FOR ALL TECHNICAL ASSISTANCE PLEASE CONTACT GENTECH INDUSTRIES ON

SOUTH AFRICA
customer@gentechindustries.co.za

NAMIBIA
customer5@gentechindustries.co.za

Telephone: +27 11 466 6790
Website: www.gentechindustries.co.za

Please note: This manual is designed for the GPWP20 and GPWP30 water pump.

FOR ALL WARRANTY INFORMATION PLEASE READ THROUGH YOUR LIMITED WARRANTY POLICY BOOKLET